

AT&T FiberLine Installation Manual

Fiber Optic LC/UPC Duplex Single Boot Cords

Polarity Switch Manual

1. Remove the push-pull tab using a small stick to push down the locking clip:

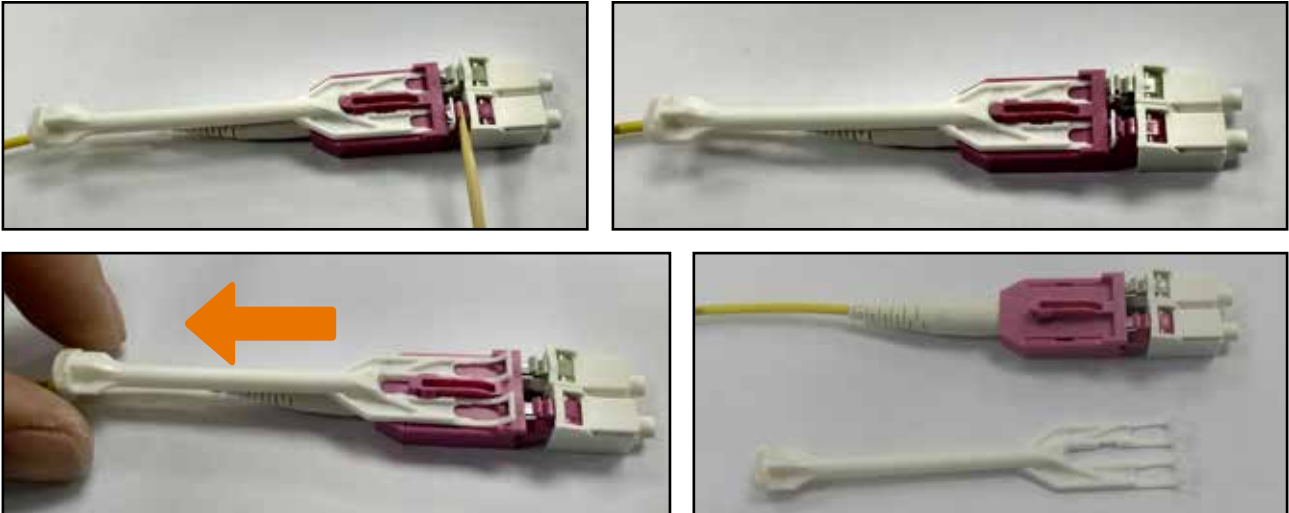

2. Unlock and remove the cover by pushing a flat tipped tool into the gap:

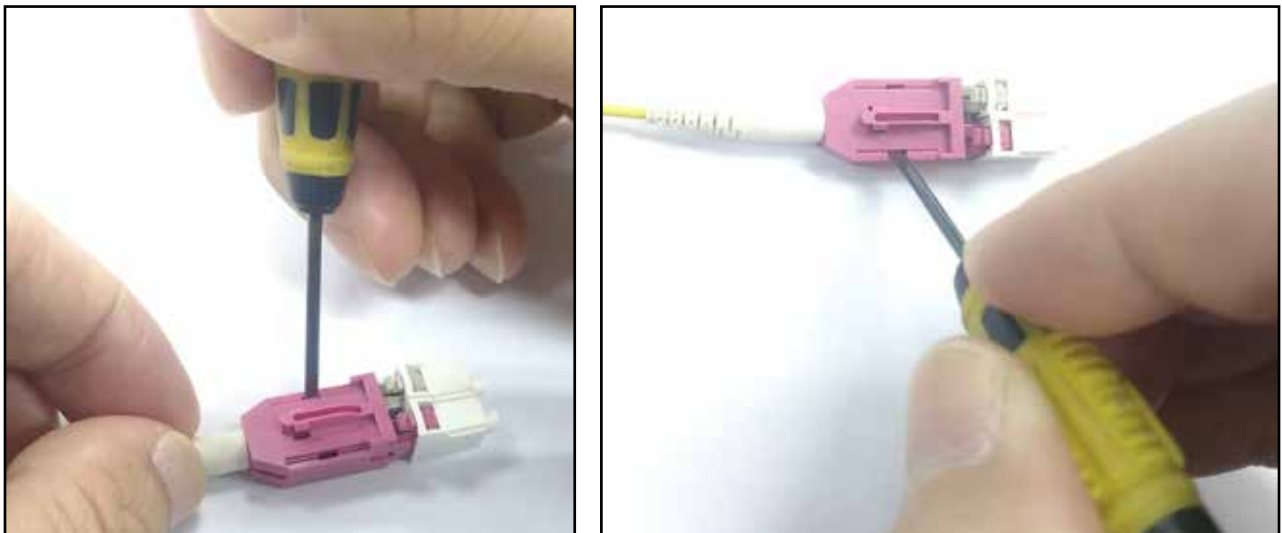

AT&T FiberLine Installation Manual

Fiber Optic LC/UPC Duplex Single Boot Cords

Polarity Switch Manual

3. Take out both connectors, swap positions and replace:

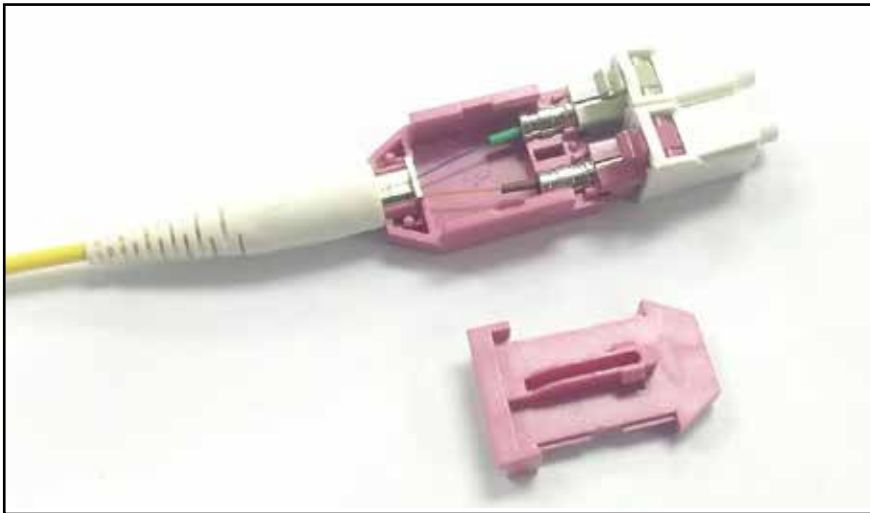

AT&T FiberLine Installation Manual

Fiber Optic LC/UPC Duplex Single Boot Cords

Polarity Switch Manual

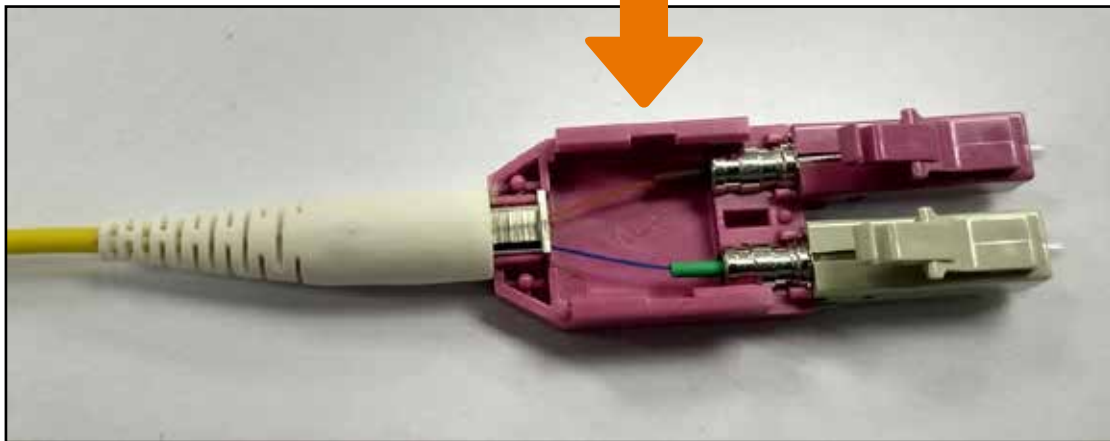
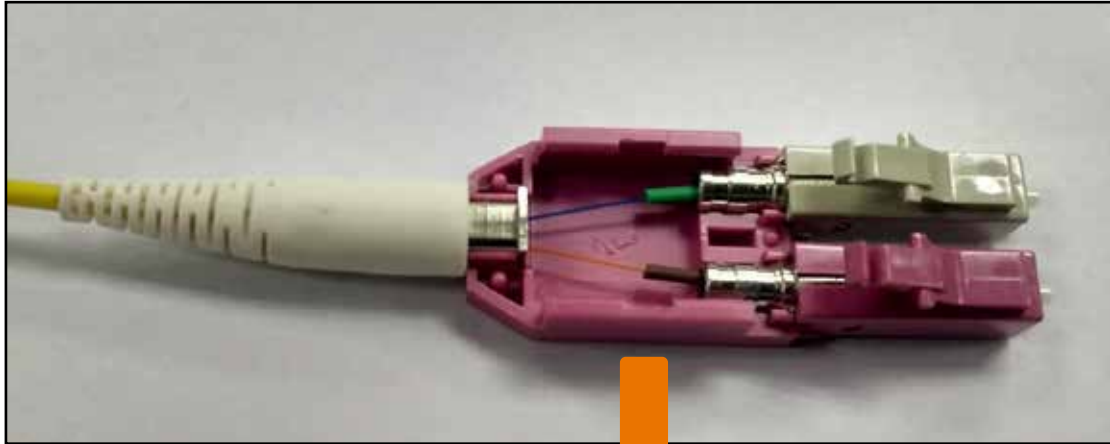

4. Insert the push-pull tab into the removed cover:

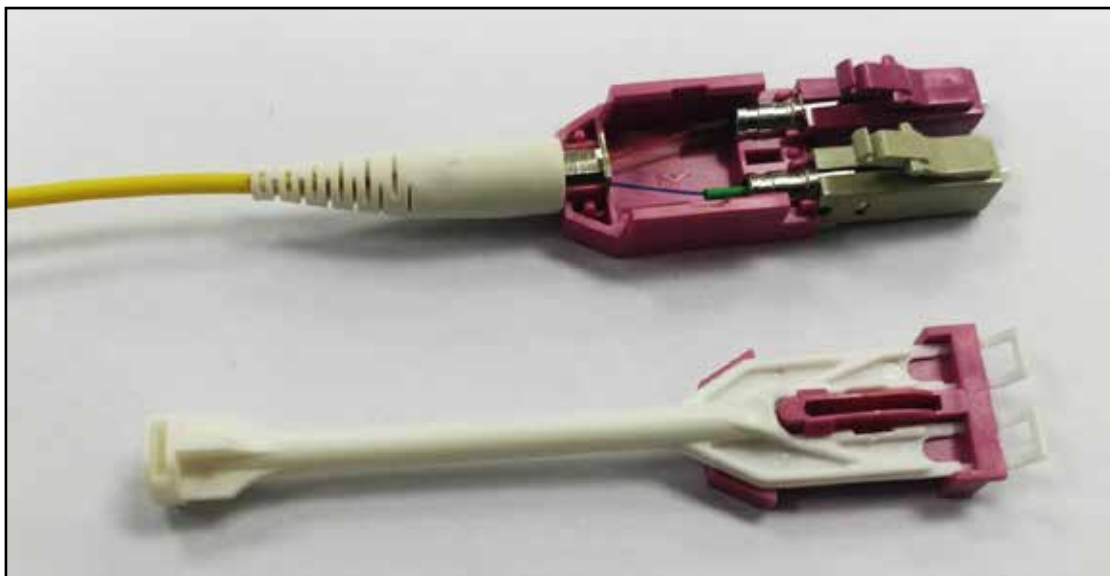

AT&T FiberLine Installation Manual

Fiber Optic LC/UPC Duplex Single Boot Cords

Polarity Switch Manual

5. Insert the push-pull tab with the cover into place and press together:

